

4STONE DOMESTIC DRAINAGE CHANNEL

NEW
PRODUCT

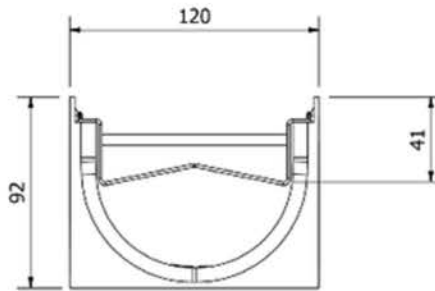

Dimensions

Length	1000mm
External width	120mm
External Height	132mm
Internal Width	95mm
Internal Height	70mm
Materials	Plastic / Galv
Weight	2.8kg

- Easy to install
- Shallow required depth
- Smooth channel surface for rainwater runoff
- A15 domestic rating
- Small or large stones placed in the grating space
- Designed in accordance with EN 1433
- Quick waterflow drainage
- Blends perfectly into any environment that requires the use of stones, small pebbles or decorative wood.

Shallow channel is ideal for limited excavation depths – for example when services are located unusually close to the surface or where sub-soil drainage would be impeded.